

ELA 3

Low voltage current transformer type ELA 3. Inside diameters $\varnothing 90$ mm.
 Max voltage $U_m = 1.2$ kV. Test voltage $U_p = 6$ kV.

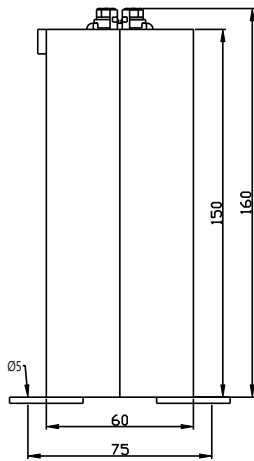
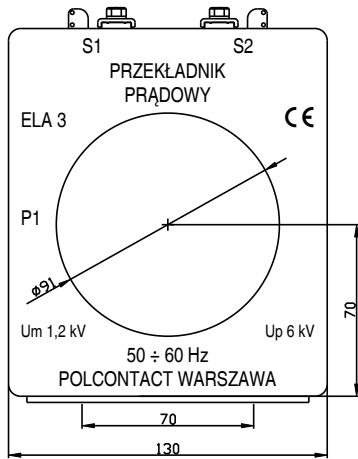

Rated secondary current $I_{sn} = 5$ or 1 A.
 Security factor for apparatus FS5.
 Other parameters available on request after consultation with our Technical Department.

Example of order: ELA 3 D 90; 1000/5 A; 5 VA; cl. 0.2S

		ELA 3					
		D 90					
I_{pn}		cl. 0.2S	cl. 0.2	cl. 0.5S	cl. 0.5	cl. 1	cl. 3
A		VA					
150						2.5	2.5
						5	5
							7.5
							10
200					2.5	2.5	2.5
						5	5
						7.5	7.5
							10
250					2.5	2.5	2.5
						5	5
						7.5	7.5
						10	10
300					2.5	2.5	2.5
					5	5	5
						7.5	7.5
						10	10
400				2.5	2.5	2.5	2.5
					5	5	5
					7.5	7.5	7.5
						10	10
500			2.5	2.5	2.5	2.5	2.5
				5	5	5	5
					7.5	7.5	7.5
					10	10	10
600		2.5	2.5	2.5	2.5	2.5	2.5
			5	5	5	5	5
				7.5	7.5	7.5	7.5
					10	10	10
750 800		2.5	2.5	2.5	2.5	2.5	2.5
		5	5	5	5	5	5
			7.5	7.5	7.5	7.5	7.5
			10	10	10	10	10
1000		2.5	2.5	2.5	2.5	2.5	2.5
		5	5	5	5	5	5
		7.5	7.5	7.5	7.5	7.5	7.5
			10	10	10	10	10
1250					15	15	15
		2.5	2.5	2.5	2.5	2.5	2.5
		5	5	5	5	5	5
		7.5	7.5	7.5	7.5	7.5	7.5
1500		10	10	10	10	10	10
			15	15	15	15	15
		2.5	2.5	2.5	2.5	2.5	2.5
		5	5	5	5	5	5
1500		7.5	7.5	7.5	7.5	7.5	7.5
		10	10	10	10	10	10
			15	15	15	15	15